

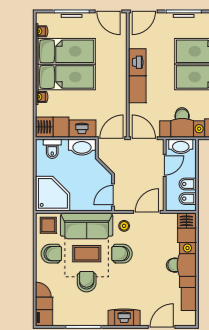

ROOMS

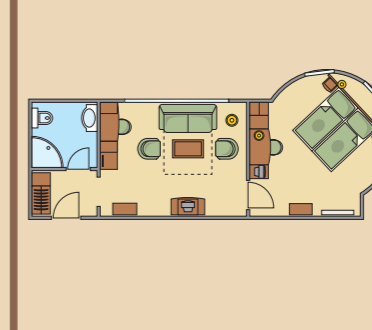

Our 58 tastefully furnished rooms and suites can accommodate 130 people. In the following part, let us present the room types and their facilities.

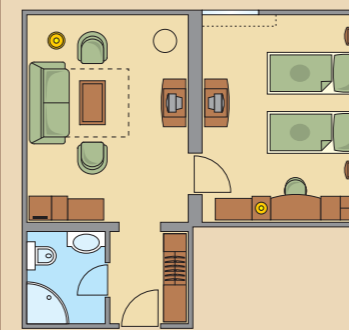
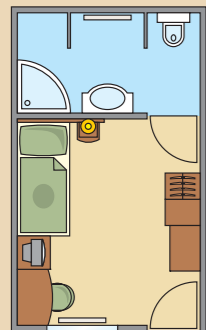

HOTEL ROOMS "ARCADE"

2 *single rooms*. They are situated in the separate "Arcade" building, built in 2006. Equipment: Single bed, bathroom with shower and toilet, TV-set, telephone and minibar. They are elegant, atmospheric, and a little smaller than the hotel rooms. They are accessible to physically challenged guests as well.

HOTEL ROOMS "ARCADE"

37 *double rooms*. They are situated in the separate "Arcade" building, built in 2006. Equipment: 2 separate beds that can be pushed together, bathroom with shower and toilet, TV-set, telephone and minibar. They are elegant, atmospheric, and a little smaller than the hotel rooms. They cannot be equipped with an extra bed.

HOTEL ROOMS

13 *double rooms*. They are situated in the new part of the main building, built in 2004. Equipment: 2 separate beds that can be pushed together, bathroom with shower and toilet, TV-set, telephone and minibar. They are air-conditioned, elegant and atmospheric. They cannot be equipped with an extra bed.

JUNIOR SUITE

It is one of the two tower rooms, situated in the new part of the main building, built in 2004. There is only one of this type of room. The bedroom and living room are not divided. The bedroom is equipped with twin bed, while in the living room there is a couch for 2 people. Equipment: bathroom with shower, toilet, TV-set, telephone and minibar. It is air-conditioned, elegant, atmospheric and spacious, ideal for families with small children.

SUITE NR. 101

It is situated in the new part of the main building, built in 2004. There is only one of this type of room, and the only one with a balcony. It has separate bedroom and living room. The bedroom is equipped with double bed, while in the living room there is a couch for 2 people. Equipment: bathroom with whirlpool bathtub and shower, toilet, TV-set, telephone and minibar. It is air-conditioned, elegant, atmospheric and spacious, ideal for families with small children.

SUITE NR. 102

It is situated in the new part of the main building, built in 2004. There is only one of this type of room. It has separate bedroom and living room. The bedroom is equipped with twin bed, while in the living room there is a couch for 2 people. Equipment: bathroom with shower, toilet, TV-set, telephone and minibar. It is air-conditioned, elegant, atmospheric and spacious, ideal for families with small children.

SUITE NR. 108

It is one of the two tower rooms, situated in the new part of the main building, built in 2004. There is only one of this type of room. It has separate bedroom and living room. The romantic tower-bedroom is equipped with double bed, while in the living room there is a couch for 2 people. Equipment: bathroom with shower, toilet, TV-set, telephone and minibar. It is air-conditioned, elegant, atmospheric and spacious, ideal for families with small children.

SUITE "ARCADE"

The 2 suites "Arcade" are situated in the separate "Arcade" building, built in 2006. Their size is 60 m², and both have two bedrooms and a big living room. The bedrooms are equipped either with double or twin bed, while in the living room there is a couch for 2 people. Equipment: spacious bathroom with shower and toilet, another separate toilet, TV-set, telephone, minibar and a nice, big terrace. They are elegant and atmospheric. They are accessible to physically challenged guests as well.